

18系列

双向刀闸阀

*Bidirectional knife gate valve*



DOWNLOAD  
DATASHEET



**b**-Smart, Be-Brandoni



**Brandoni**  
VALVES

[www.brandonivalves.com](http://www.brandonivalves.com)

## 双向刀闸阀 / Bidirectional knife gate valve

18系列双向刀闸阀阀体材质为铸铁或不锈钢。严格按照相关产品质量标准生产，符合EN ISO 9001质量标准。

该系列可定制不同密封件，也可以做成正方形。

适用于水系统、压缩空气、污水系统和水净化系统、化工食品工业系统。使用介质可以为粘性或带固体悬浮颗粒的液体。

(请确保您的选择与适用范围一致)。

可提供与使用介质一致的各类密封件。

该系列刀闸阀一般都是明杆的，也可提供暗杆式，可安装多种驱动器和附件。

**YES:** 可以用于节流和调节流量，带自我清洁功能。

### 附件

- V型腔
- 机械限位开关
- 链条驱动
- 连接方头
- 保护装置 (安装气动执行器时)
- 刮刀
- 电磁阀 (用于安装气动执行器)

### 驱动器

- 气动或电动执行器
- 齿轮箱
- 链条驱动装置
- 操作手柄

### 认证 / Certifications



结构及检测标准:

结构长标准: EN 558-1 ISO 5752

法兰标准: EN 1092 ISO 7005

标识标准: EN19

检测标准: EN 12266

The bidirectional knife gate valves in Series 18 have a cast iron or stainless steel body, which is produced in conformity with the relevant product norms and in conformity with EN ISO 9001 quality requirements.

They are available with various seals and, on request, may be manufactured with a square shape.

Those valves are suitable for water plants, pneumatic plants, waste water and purification plants, and for the chemical and food industries. Furthermore, they are suitable for handling viscous liquids, and liquids with solid parts in suspension.

(Please ensure the choice of the corresponding item).

The seals are available in different materials, for use with the various fluids/service media.

These valves are supplied, as standard, with a rising stem. On request, they can be fitted with a non-rising stem, as well as with a wide range of actuators and accessories available for this series.

**YES:** for choking and regulation of the flow. Self-cleaning.

### Accessories

- V-port
- Mechanical limit switches
- Chain driver
- Square cap
- Hand-protection for pneumatic actuator
- Scraper
- Solenoid valve for pneumatic actuator

### Actuator and drives

- Pneumatic and electric actuators
- Gear boxes
- Chain driver
- Operation lever

**Design and testing standards (correspondences):**

Face-to-face: EN 558-1 ISO 5752

Flanges: EN 1092 ISO 7005

Marking: EN19

Testing: 100% testing in accordance with EN 12266

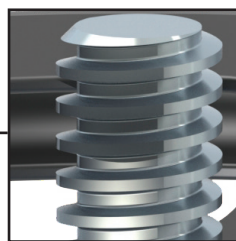

明杆（也可是暗杆）。  
Standard rising stem (non-rising stem on request).

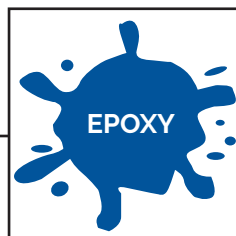

铸铁阀体时，表面喷涂环氧树脂 RAL5017。  
Versions with a cast iron body: epoxy coating RAL 5017.

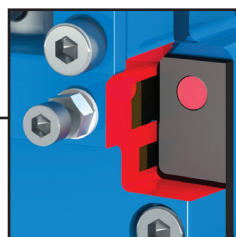

可安装刮刀用于清洁闸板。  
可调节螺栓，用于闸板填料调整。  
Possibility of installing a scraper for cleaning the gate.  
Adjustment screws for gate packing.



阀体由两部分对接而成，便于维护。  
Construction in 2 parts, in order to facilitate maintenance

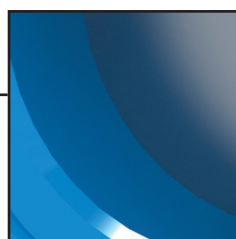

无凹腔设计可防止杂质堆积，能够自我清洁。  
The absence of a cavity prevents the deposit of material, self-cleaning

双向使用。  
结构紧凑。  
Bidirectional.  
Compact design.

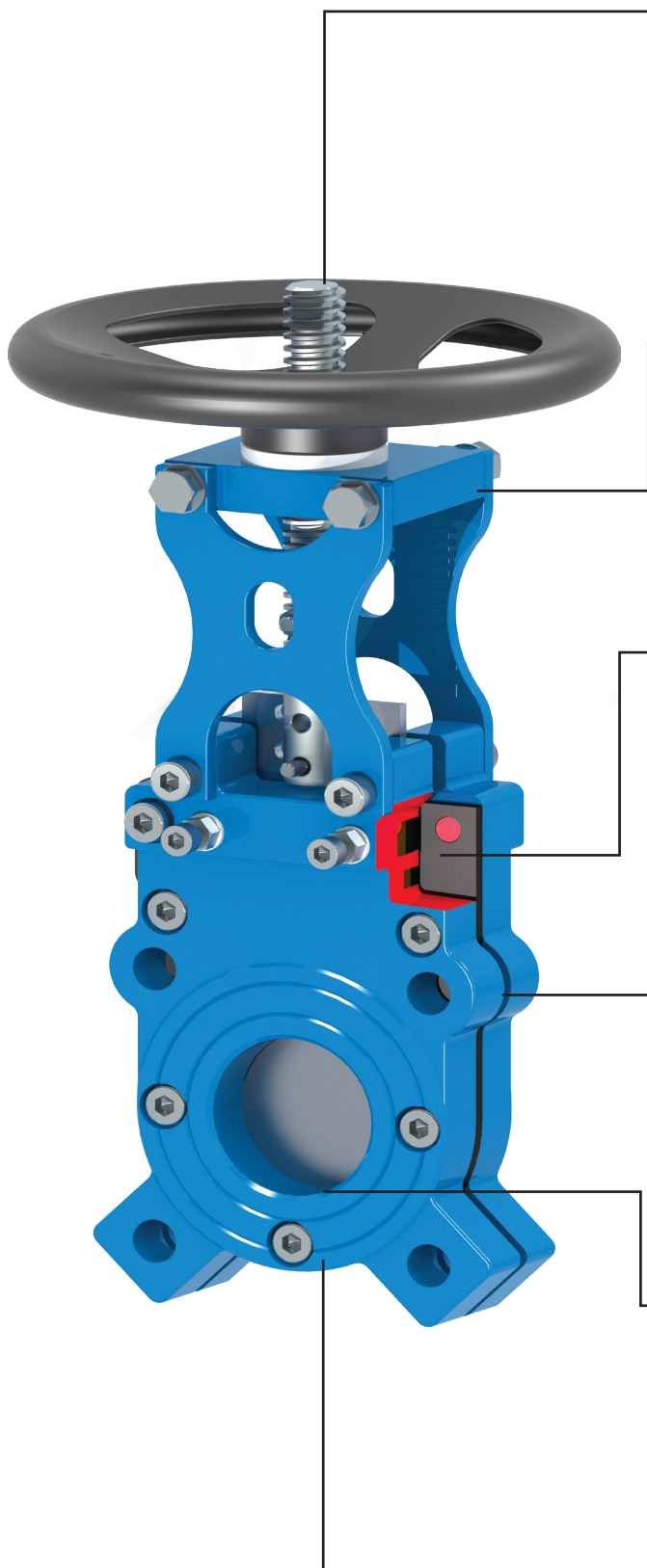

## 双向刀闸阀 / Bidirectional knife gate valve

### 铸铁阀体 / Cast iron body



#### 18.001

阀体: EN GJL 250  
 闸板: AISI 316  
 密封: NBR  
 工作温度: -30 + 80 °C

Body: cast iron  
 Gate: AISI 316  
 Seal: NBR  
 Temp: -30 +80°C



#### 18.009

阀体: EN GJL 250  
 闸板: AISI 316  
 密封: EPDM  
 工作温度: -30 + 90 °C

Body: cast iron  
 Gate: AISI 316  
 Seal: EPDM  
 Temp: -30 +90°C

### AISI 316不锈钢阀体 / AISI 316 body



#### 18.601

阀体: AISI 316  
 闸板: AISI 316  
 密封: NBR  
 工作温度: -30 + 80 °C

Body: AISI 316  
 Gate: AISI 316  
 Seal: NBR  
 Temp: -30 +80°C



#### 18.602

阀体: AISI 316  
 闸板: AISI 316  
 密封: FKM  
 工作温度: -40 + 180 °C

Body: AISI 316  
 Gate: AISI 316  
 Seal: FKM  
 Temp: -40 +180°C



#### 18.603

阀体: AISI 316  
 闸板: AISI 316  
 密封: PTFE  
 工作温度: -10 + 200 °C

Body: AISI 316  
 Gate: AISI 316  
 Seal: PTFE  
 Temp: -10 +200°C

### AISI 316不锈钢阀体 / AISI 316 body



#### 18.609

阀体: AISI 316  
 闸板: AISI 316  
 密封: EPDM  
 工作温度: -30 + 90 °C

Body: AISI 316  
 Gate: AISI 316  
 Seal: EPDM  
 Temp: -30 +90°C



#### 23

可定制直通刀板

On request available with  
 through blade

**18 + RM**

齿轮箱  
Gear box

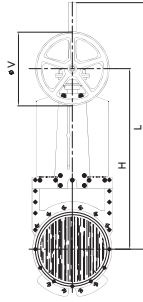

DN	50	65	80	100	125	150	200	250	300	350	400	450	500	600
<b>18 + RM</b>														
L	-	-	-	-	-	-	-	-	-	1370	1530	1667	1829	2116
H	-	-	-	-	-	-	-	-	-	980	1090	1164	1276	1463
V	-	-	-	-	-	-	-	-	-	400	400	500	500	500
重量 / Weight Kg	-	-	-	-	-	-	-	-	-	120	135	205	225	300



**18 + AUMA**

电动执行器  
Electric actuators

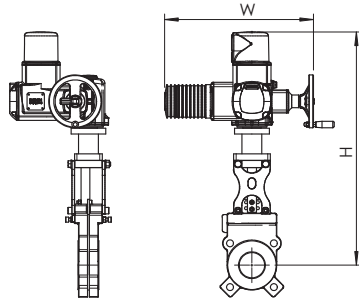

DN	50	65	80	100	125	150	200	250	300	350	400	450	500	600
<b>18 + AUMA</b>														
H	335	376	419	476	541	651	903	954	1137	1273	1433	1604	1779	2066
W	514	514	514	514	514	514	514	537	537	537	537	728	728	728
重量 / Weight Kg	29	30	33	32	38	48	64	84	108	136	169	274	339	409



**18 + AP**

气动执行器  
Pneumatic actuators

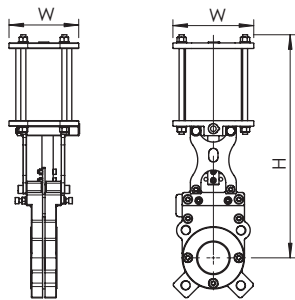

DN	50	65	80	100	125	150	200	250	300	350	400	450	500	600
<b>18 + AP DE - DA</b>														
H	374	413	461	518	593	709	871	1020	1194	1351	1511	1664	1838	2125
W	80	80	100	100	125	160	190	190	190	250	250	300	300	300
重量 / Weight Kg	11	12	15	17	22	33	46	75	87	158	175	255	305	390

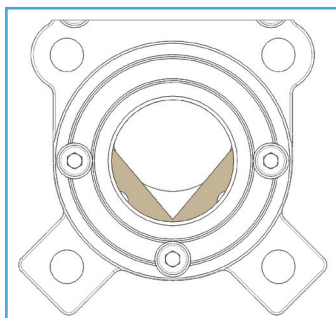

**V型腔**

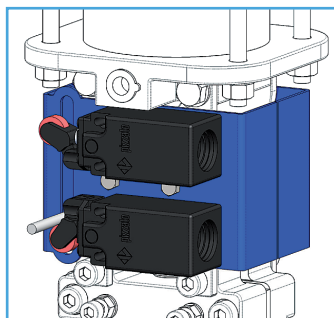

**18.LS**

机械限位开关  
Mechanical limit switch



**KCAT18**

链条驱动装置 (4米)  
Chain driver kit (4 m)

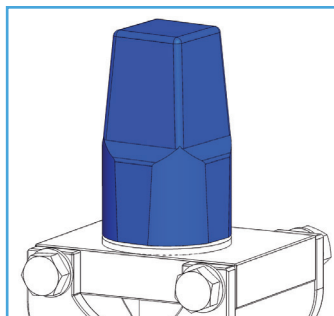

**18.CAP**

连接方头  
Square cap

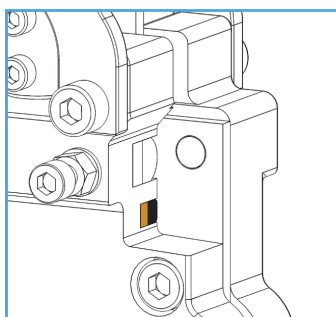

**18RX**

刮刀  
Scraper

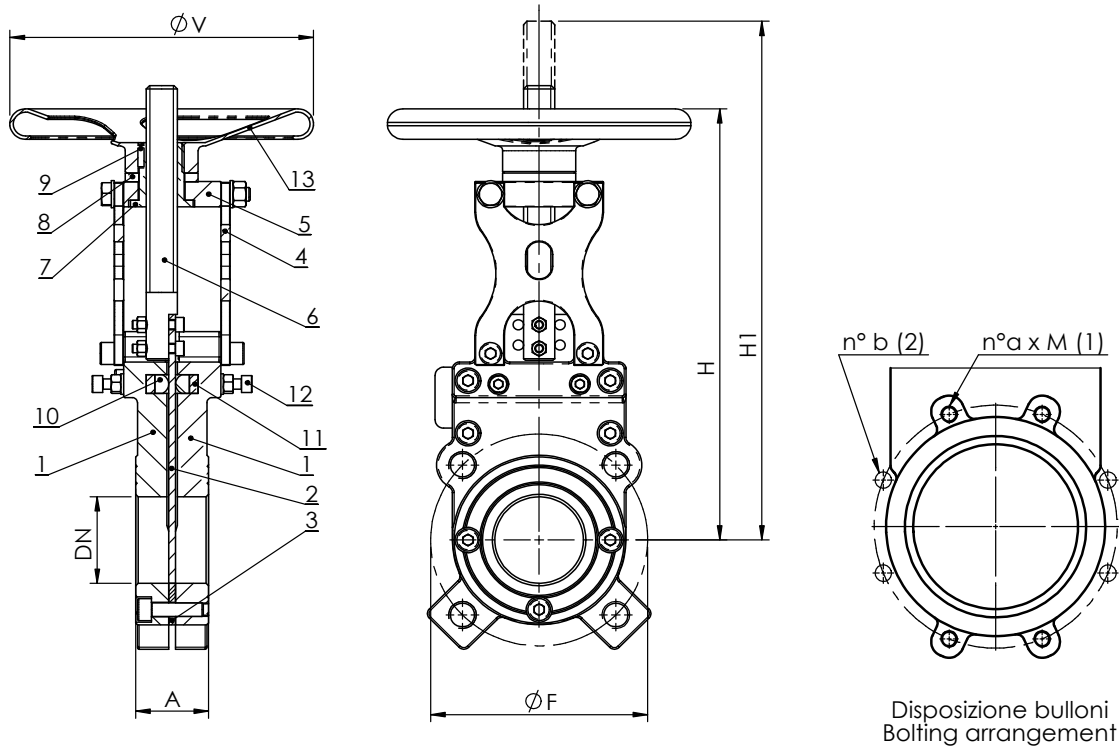

## 材质 / Materials

	组件 - Component	材质 - Material	
		18.0	18.6
1	阀体 - Body	铸铁 - Cast iron EN GJL 250 EN 1561	不锈钢 - Stainless steel ASTM A351 CF8M
2	闸板 - Gate	不锈钢 - Stainless steel AISI 316	不锈钢 - Stainless steel AISI 316
3	阀座 - Seat	NBR / EPDM / FKM (Viton®) / PTFE	NBR / EPDM / FKM (Viton®) / PTFE
4	撑板 - Plates	球铁 (环氧树脂喷涂) - Ductile iron, epoxy coated	球铁 (环氧树脂喷涂) - Ductile iron, epoxy coated
5	轴套 - Bearing	球铁 (环氧树脂喷涂) - Ductile iron, epoxy coated	球铁 (环氧树脂喷涂) - Ductile iron, epoxy coated
6	阀杆 - Stem	不锈钢 - Stainless steel AISI 316	不锈钢 - Stainless steel AISI 316
7	螺母 - Nut	青铜 - Bronze	青铜 - Bronze
8	滑动垫圈 - Sliding washer	PTFE	PTFE
9	双头螺栓 - Stud bolt	不锈钢 - Stainless steel AISI 316	不锈钢 - Stainless steel AISI 316
10	填料 - Packing	NBR	NBR
11	填料函 - Packing support	不锈钢 - Stainless steel AISI 316	不锈钢 - Stainless steel AISI 316
12	填料调整螺栓 - Packing adjustment screw	不锈钢 - Stainless steel AISI 316	不锈钢 - Stainless steel AISI 316
13	手轮 - Hand wheel	球铁 (环氧树脂喷涂) - Ductile iron, epoxy coated	球铁 (环氧树脂喷涂) - Ductile iron, epoxy coated
-	螺栓 - Bolts	不锈钢 - Stainless steel A4	不锈钢 - Stainless steel A4

## 尺寸 (mm) / Dimensions (mm)

DN		50	65	80	100	125	150	200	250	300	350	400	450	500	600
A	EN 558/1-20	43	46	46	52	56	56	60	68	78	78	90	90	95	105
H		267	293	334	371	411	500	602	703	835	921	1'031	1'161	1'271	1'458
H1		335	376	419	476	541	651	903	954	1'137	1'273	1'433	1'604	1'779	2'066
V		175	175	225	225	225	300	300	300	400	400	400	500	500	500
法兰 Flanges	EN 1092/2	PN 10	PN 10	PN 10	PN 10	PN 10	PN 10	PN 10	PN 10	PN 10	PN 10	PN 10	PN 10	PN 10	PN 10
F		125	145	160	180	210	240	295	350	400	460	515	565	620	725
n° a x M (1)		4 x M16	4 x M16	4 x M16	4 x M16	4 x M16	4 x M20	4 x M20	6 x M20	6 x M20	10 x M20	10 x M24	12 x M24	12 x M24	14 x M27
n° b (2)		-	-	4	4	4	4	4	6	6	6	6	8	8	6

1: 阀体螺纹孔数量 / tapped holes - 2: 双头螺栓数量 / through holes

## 重量 (kg) / Weight (kg)

kg		7	8	11	13	15	24	35	55	67	120	135	205	225	300
----	--	---	---	----	----	----	----	----	----	----	-----	-----	-----	-----	-----

## 双向刀闸阀 / Bidirectional knife gate valve

## 最大工作压力 / Maximum pressure

DN	压力 - Pressure
DN 50-200	10 bar
DN 250-300	7 bar
DN 350-400	6 bar
DN 450-600	4 bar

## 工作温度 / Temperature (°C)

温度 - Temperature	最低 - Min	最高 - Max
EPDM	-30	90
NBR	-30	80
FKM (Viton®)	-40	180
PTFE	-10	200

水头损失 阀门全开时。介质：水 (1m H<sub>2</sub>O = 0,098bar)

**Head loss Valve completely open. Fluid: water (1m H<sub>2</sub>O = 0,098bar)**

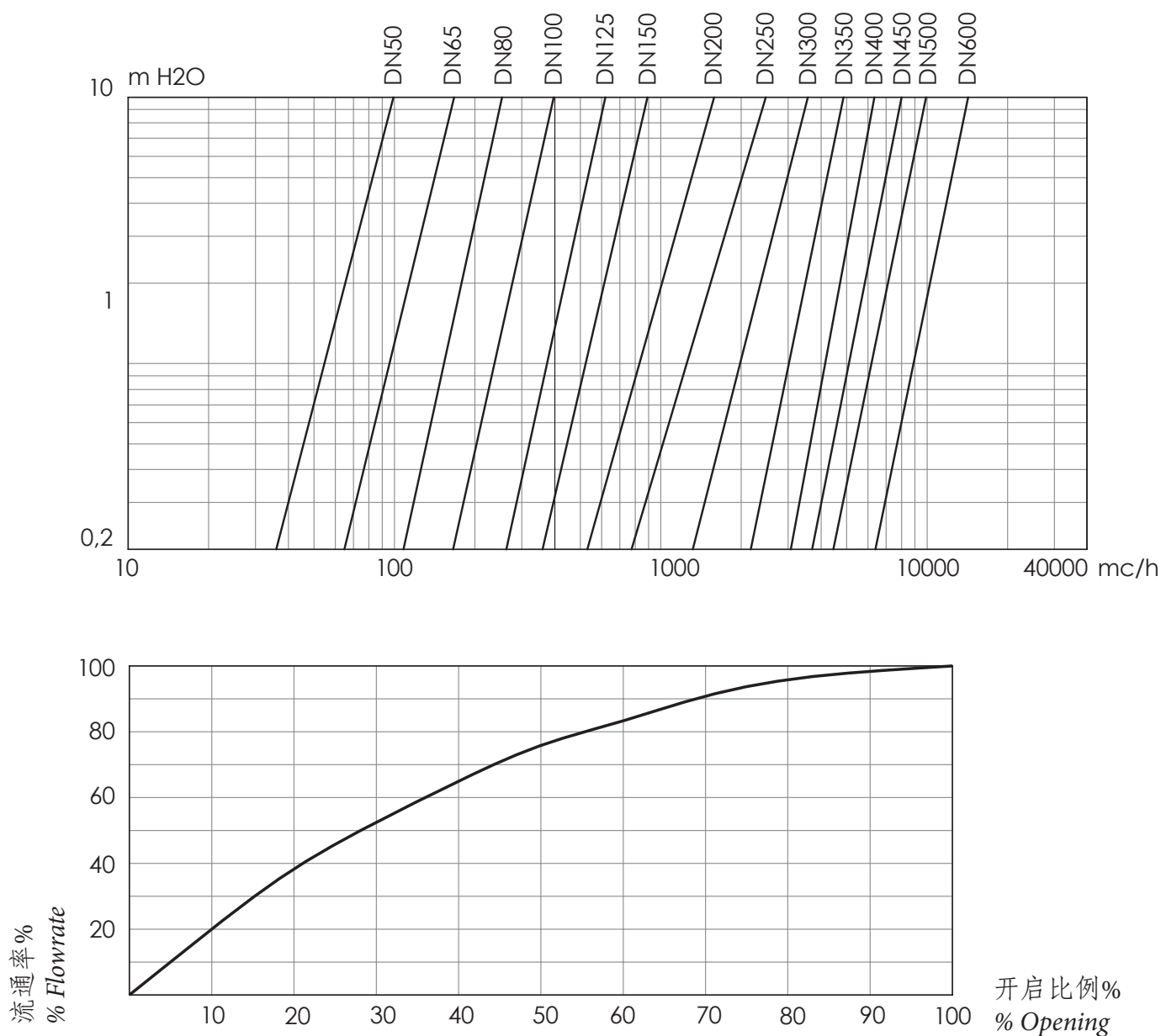

## Kv - DN表 / Kv - DN chart

DN	50	65	80	100	125	150	200	250	300	350	400	450	500	600
Kv	99	167.2	253.3	395.8	618.5	890.6	1583.4	2474	3562.6	4849	6335	8015	9896	14250

Brandoni S.p.A.保留随时更改产品设计和/或构造的权利，恕不另行通知。更多信息，请访问 [www.brandonivalves.com](http://www.brandonivalves.com)

Brandoni SpA reserves the right to make changes in design and/or construction of the products at any time without prior notice. For further information, please refer to [www.brandonivalves.com](http://www.brandonivalves.com)