

# 01.622系列

不锈钢对夹式法兰球阀

*Wafer stainless steel flanged ball valve*



DOWNLOAD  
DATASHEET

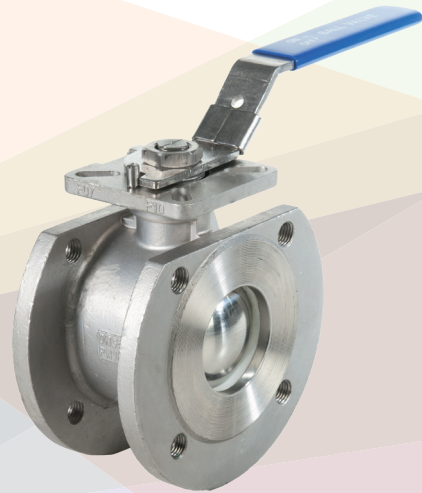

**b**-Smart, Be-Brandoni



**Brandoni**  
VALVES

[www.brandonivalves.com](http://www.brandonivalves.com)

## 不锈钢对夹式法兰球阀 / Wafer stainless steel flanged ball valve

此系列球阀阀体材质为CF8-M不锈钢，球体为浮球，严格按照相关的产品质量标准生产，符合ISO 9001标准。可分为以下几类：

**01.622 PN 40** > DN 50

**01.622 PN 16** > DN 65 – DN 100

适用于化工和工业系统，供热和空调系统，集中供热，农业系统，介质可以是油类及碳氢化合物。（请确保您的选择与适用范围一致）

**YES:** 可安装于管路中部及末端（如警示图1），可频繁开启，可连接手动、电动和气动执行器。

全口径可有效减少流体扰动和水头损失。

**NO:** 不适用于蒸汽系统及流量调节。

The series consists of shut-off wafer ball valves with the body in stainless steel CF8-M with a floating ball, manufactured in accordance with the most severe product standards and the quality management of ISO 9001. They are available in the following versions:

**01.622 PN 40** > up to DN 50

**01.622 PN 16** > from DN 65 to DN 100

Suitable for chemical and industrial plants, for heating and conditioning (HVAC), district heating, agricultural applications, oils and hydrocarbons. (Please ensure the choice of the corresponding item)

**YES:** for installation in line and end of line (see warning fig. 1), for services with frequent actuation, suitable for installation of manual, electric and pneumatic servo commands.

Full and straight bore reducing turbulences and minimizing head loss.

**NO:** for steam, for choking and regulation of the flow.

### 驱动器

- 气动执行器：单作用/双作用
- 电动执行器
- 齿轮箱

### Actuators

- Double acting and single acting pneumatic actuators
- Electric actuators
- Gear box

### 认证 / Certifications



符合2014/68/UE (ex 97/23/CE PED) 标准

In conformity with directive 2014/68/UE (ex 97/23/CE PED)

#### 结构及检测标准：

法兰标准：EN 1092 ISO 7005

结构长标准：非标准

设计标准：EN12516, ISO 5211

检测标准：EN 12266 cat. A (ISO 5208 cat. A)

#### Design and testing standards (correspondences):

Flanges: EN 1092 ISO 7005

Face-to-face: Not standardized

Design: EN12516, ISO 5211

Testing: in accordance with EN 12266 cat. A (ISO 5208 cat. A)

图1/ Fig. 1

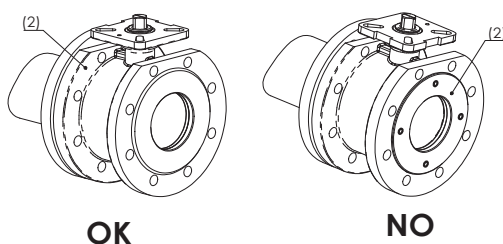

**警告。** 如果安装在管路末端，必须在管路侧通过环形螺母(2)安装阀门。不能在将螺母拧紧后再去安装阀门。

**Warning.** For end of line mounting, valve must be installed with ring nut (2) on the pipe side. Do not install the valve with the ring nut placed on the free side.

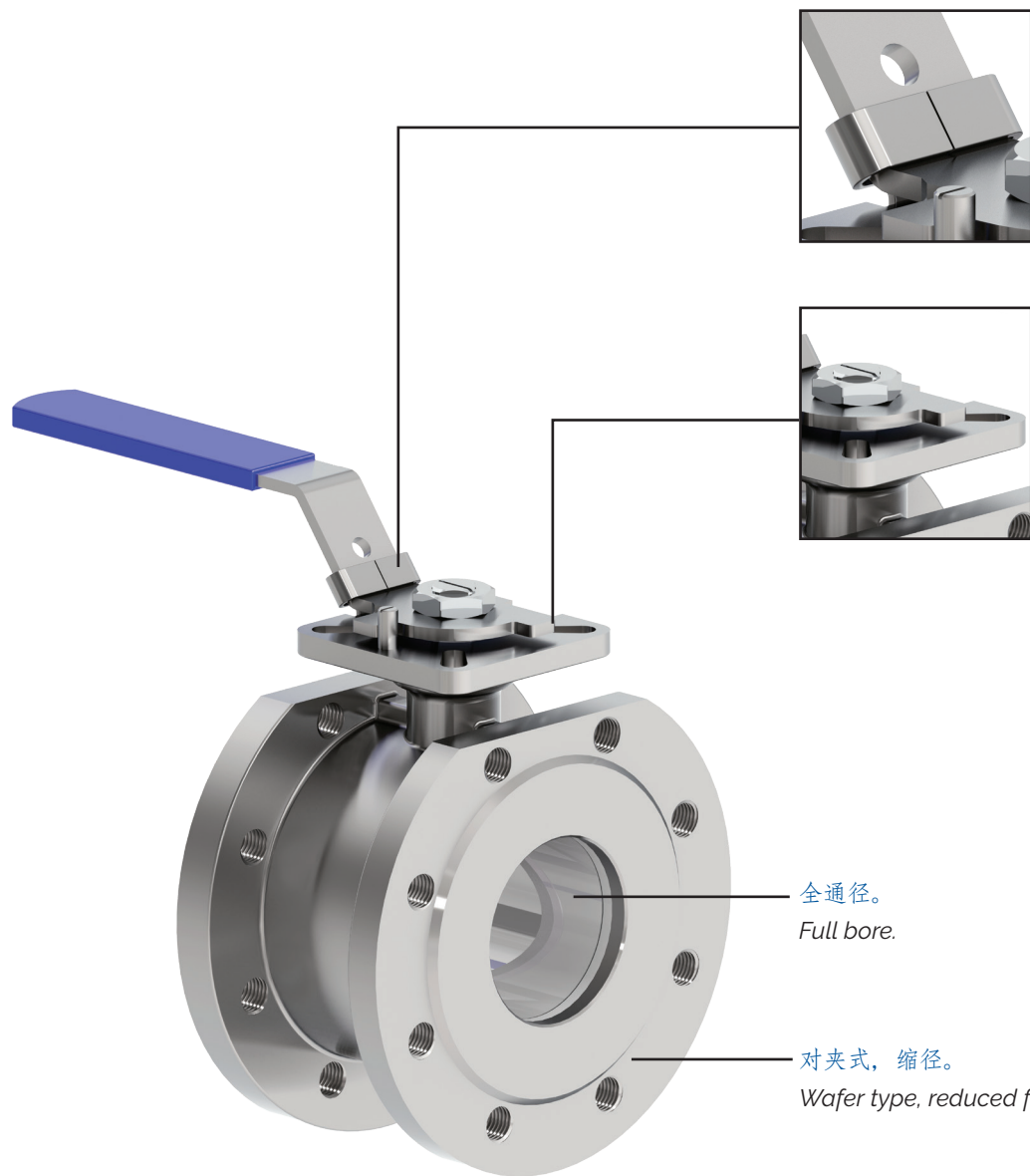

可锁定。  
*Lockable.*

ISO 5211标准上法兰。  
*With ISO 5211 flange integrated.*

全通径。  
*Full bore.*

对夹式，缩径。  
*Wafer type, reduced face to face.*

## 不锈钢对夹式法兰球阀 / Wafer stainless steel flanged ball valve

### ASTM A351 CF8M



#### 01.622

阀体: AISI316  
 阀球: AISI316  
 阀杆: AISI316  
 工作温度: -25 +150 °C

Body: Stainless steel  
 Ball: Stainless steel  
 Stem: Stainless steel  
 Temp: -25 +150 °C

### 驱动器和附件 / Actuators and accessories

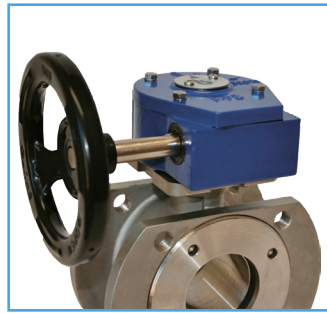

#### 01.622 + RM

齿轮箱  
 Gear box

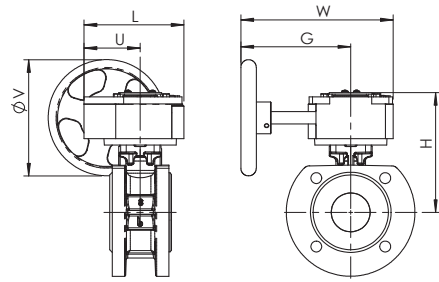

DN	15	20	25	32	40	50	65	80	100
01.622 + RM	RM.0250	RM.0250	RM.0250	RM.0250	RM.0250	RM.0250	RM.0250	RM.0250	RM.0250
L	130	130	130	130	130	130	130	130	130
U	77	77	77	77	77	77	77	77	77
H	117,3	122,3	120,4	132,5	138,5	146,5	156,5	172,5	174,5
W	225	225	225	225	225	225	225	225	225
G	170	170	170	170	170	170	170	170	170
V	150	150	150	150	150	150	150	150	150
重量 / Weight Kg	5,41	5,78	6,23	7,4	8,5	9,67	12,5	16,2	21,2

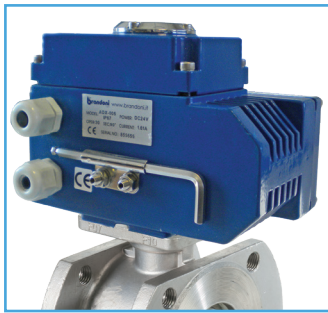

#### 01.622 + AOX

电动执行器  
 Electric Actuators

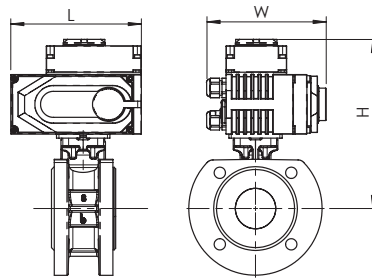

DN	15	20	25	32	40	50	65	80	100
01.622 + AOX	003	003	003	003	005	005	008	015	020
L	123	123	123	123	160	160	160	189	268
H	168	173	171	184	198	206	216	240	277
W	100	100	100	100	121	121	121	145	225
重量 / Weight Kg	3,21	3,58	4,03	5,2	7,8	8,97	11,8	16,5	29,9



#### 01.622 + AP

气动执行器  
 Pneumatic actuator

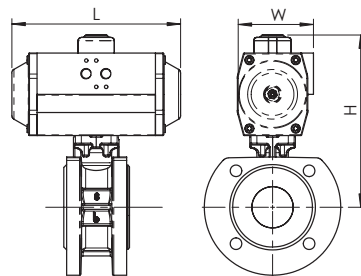

DN	15	20	25	32	40	50	65	80	100
01.622 + AP DE - DA	AP1	AP1	AP2	AP2	AP3	AP3	AP3.5	AP4	AP4.5
L	142	142	155	155	213	213	236	276	310
H	142	147	161	174	197	205	225	256	285
W	60	60	73	73	85	85	98	110	128
重量 / Weight Kg	2,11	2,48	3,35	4,52	6,74	7,91	11,88	17	25,14
01.622 + AP SE - 弹簧复位 / SPRING RETURN	AP2S	AP2S	AP3S	AP3S	AP3.5S	AP3.5S	AP4.5S	AP5S	AP5.5S
L	155	155	213	213	236	236	310	366	388
H	158	163	178	191	207	215	267	296	379
W	73	73	85	85	98	98	128	140	160
重量 / Weight Kg	2,67	3,04	5,03	6,2	8,5	9,67	17,87	24,52	33,99

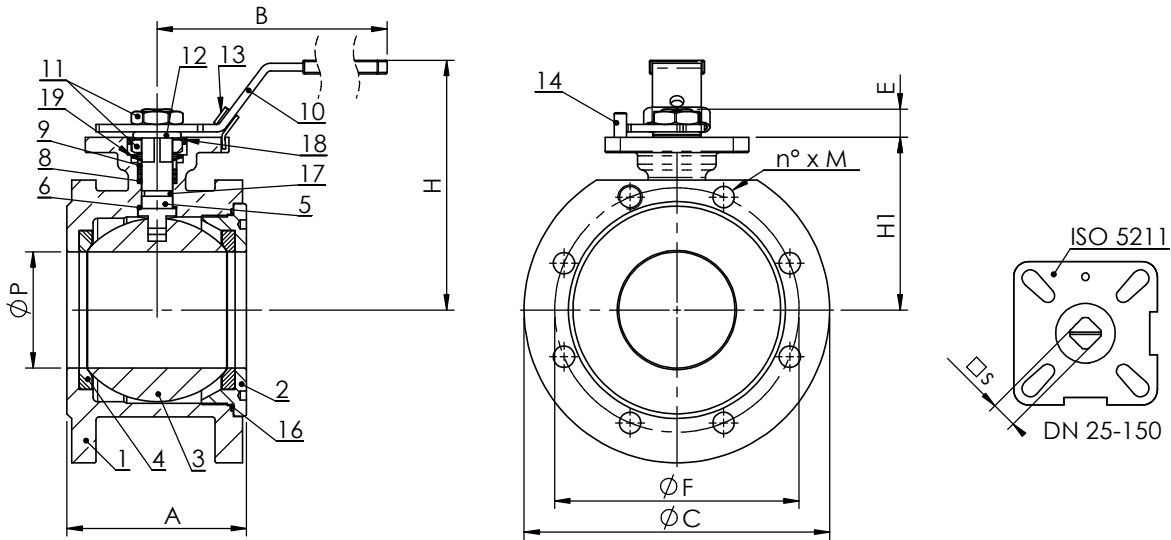

## 材质 / Materials

组件 - Component	材质 - Material
1 阀体 - Body	不锈钢 - Stainless steel ASTM A351 CF8M
2 环形螺母 - Ring nut	不锈钢 - Stainless steel ASTM A351 CF8M
3 球阀 - Ball	不锈钢 - Stainless steel AISI 316
4 球座 - Ball seat	加强型PTFE - Reinforced PTFE
5 阀杆 - Stem	不锈钢 - Stainless steel AISI 316
6 滑动垫圈 - Sliding washer	PTFE
8 阀杆填料 - Stem packing	PTFE
9 压块 - Pressing bush	不锈钢 - Stainless steel AISI 304
10 手柄 - Lever	AISI 304 (带塑料把套) - AISI 304 with plastic sleeve
11 内六角螺母 - Hex nut	不锈钢 - Stainless steel AISI 304
12 圆环 - Ring	不锈钢 - Stainless steel AISI 304
13 定位板 - Stop plate	不锈钢 - Stainless steel AISI 304
14 限位柱 - Stop pin	不锈钢 - Stainless steel AISI 304
16 阀体密封圈 - Body seal	PTFE
17 O型圈 - O-ring	FKM (Viton®)
18 垫片 - Spacer	不锈钢 - Stainless steel AISI 304
19 蝶形弹簧 - Belleville Spring	不锈钢 - Stainless steel AISI 301

## 尺寸 (mm) / Dimensions (mm)

DN	15	20	25	32	40	50	65	80	100	
P	15	20	25	32	40	50	65	76	94	
A	非标准 Not standardized	36	38	53	53	65	78	98	118	140
H	89	94	90	100	105	125	140	145	175	
H1	55.3	60.3	58.4	70.5	76.5	84.5	94.5	110.5	122.5	
B	120	120	160	160	200	200	255	255	300	
C	95	105	115	140	150	165	185	200	220	
F	EN 1092/1 PN40	65	75	85	100	110	125	-	-	
F	EN 1092/1 PN16	-	-	-	-	-	-	145	160	180
n° x M	4 x M12	4 x M12	4 x M12	4 x M16	4 x M16	4 x M16	4 x M16	8 x M16	8 x M16	
ISO 5211	F03/04	F03/04	F04/F05	F04/F05	F05/F07	F05/F07	F07/F10	F07/F10	F07/F10	
E	9.5	9.5	10	12.5	14.5	14	17	16	19	
S	9	9	11	11	14	14	17	17	17	

## 重量 (kg) / Weight (kg)

kg	1.11	1.48	1.93	3.1	4.2	5.37	8.2	11.9	16.9
----	------	------	------	-----	-----	------	-----	------	------

## 扭矩 (Nm) / Operating torque (Nm)

Nm	5	8	10	14	18	25	48	75	110
----	---	---	----	----	----	----	----	----	-----

注意：请将扭矩数值乘以1.5倍作为选择驱动装置的依据。

N.B.: In order to choose the right actuator, we recommend multiplying the operating torque figure by a safety coefficient, K=1.5

## 不锈钢对夹式法兰球阀 / Wafer stainless steel flanged ball valve

### 最大工作压力 / Maximum pressure

类型 - Article	压力 - bar
01.622 DN 15 - 50	40 bar
01.622 DN 65 - 100	16 bar

### 工作温度 / Temperature (°C)

温度 - Temperature	最低 - Min	最高 - Max
	-25	150

注意：温度上升时最大工作压力会有所下降；详情请参考压力温度曲线  
 NB: the maximum working pressure decreases while the temperature increases; please refer to "pressure/temperature"

### 压力温度曲线 - Pressure/temperature chart

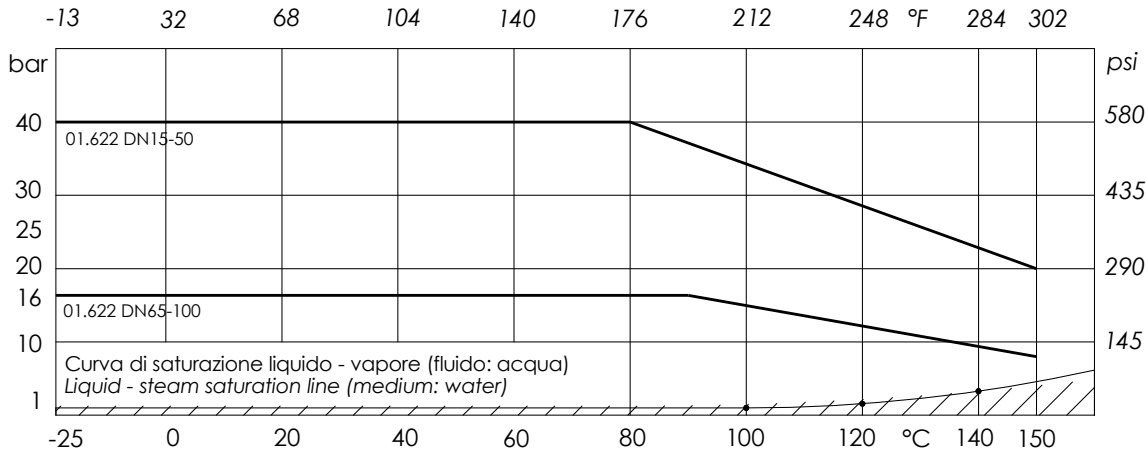

不适用于蒸汽系统。当工作温度和压力处于饱和蒸汽压曲线（阴影区域）下方时，请勿使用该阀门。  
 RANGE NOT SUITABLE FOR STEAM. DO NOT use when temperature and pressure are below the liquid-steam saturation line (hatched area)



### 水头损失 介质：水 (1m H<sub>2</sub>O = 0,098bar) / Head loss Fluid: water (1m H<sub>2</sub>O = 0,098bar)

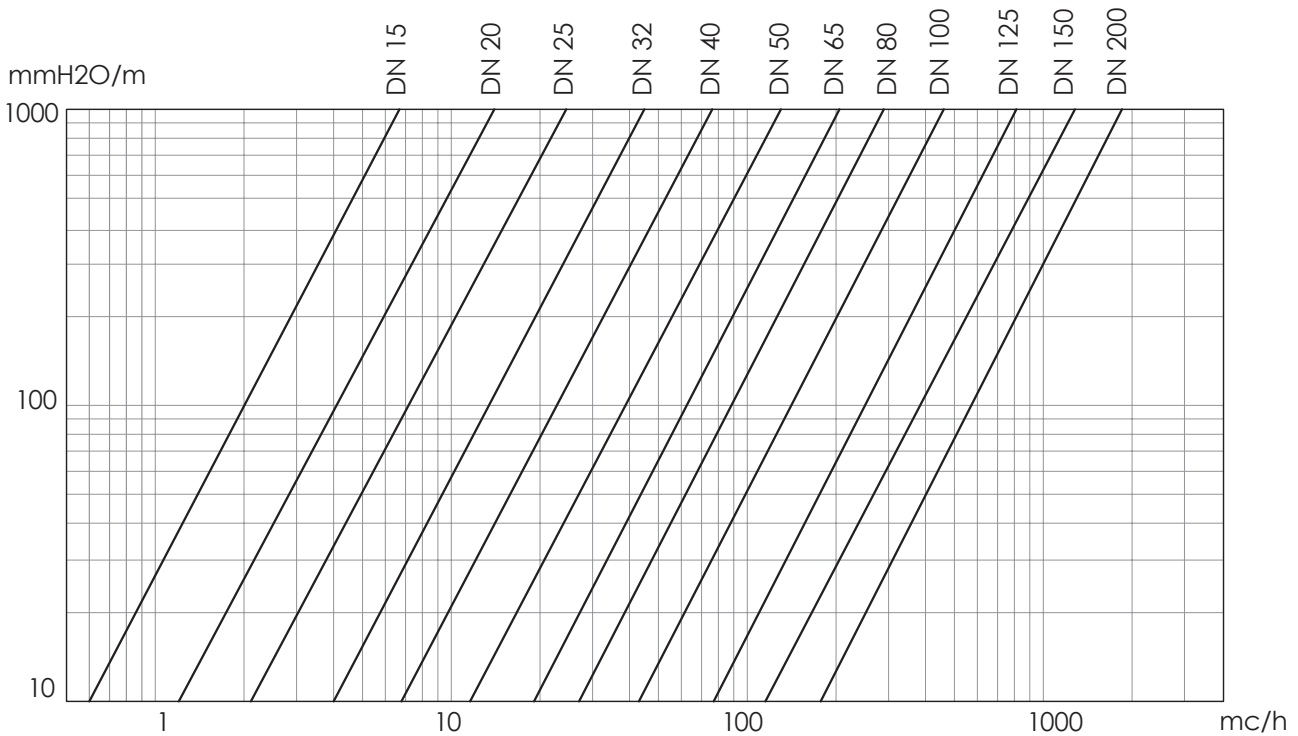

### Kv - DN表 / Kv - DN chart

DN	15	20	25	32	40	50	65	80	100	125	150	200
Kv	22.3	47.7	83.5	150.4	255	435	672	947	1'508	2'633	4'261	5'957

Brandoni S.p.A保留随时更改产品设计和/或构造的权利，恕不另行通知。更多信息，请访问 [www.brandonivalves.com](http://www.brandonivalves.com)

Brandoni SpA reserves the right to make changes in design and/or construction of the products at any time without prior notice. For further information, please refer to [www.brandonivalves.com](http://www.brandonivalves.com)